

CUSTOMER COPY

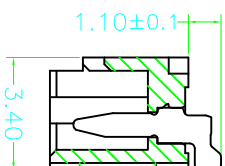

SECTION E-E

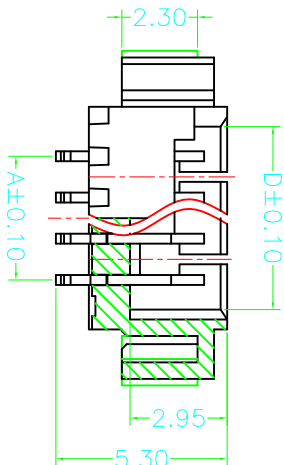
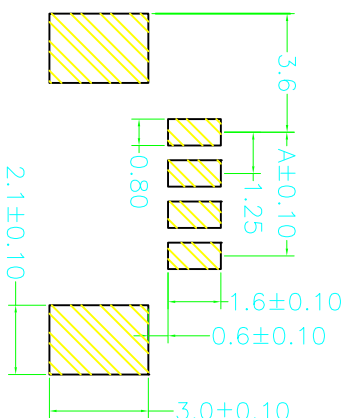
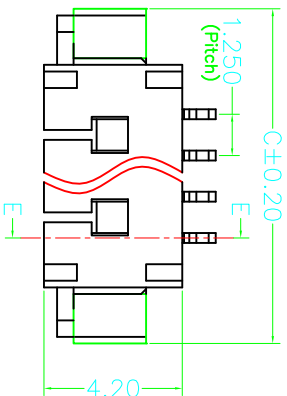
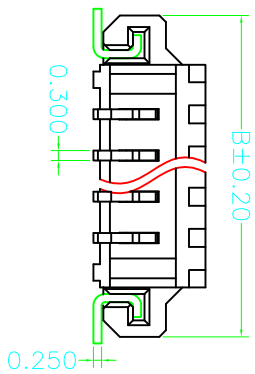

RECOMMENDED P. C. B LAYOUT

NOTE:

1. Material
 - 1.1: Housing: LCP UL94-V0 Color: Nature.
 - 1.2: Contact: BRASS T=0.30MM.
 - 1.3: LEG: BRASS T=0.25MM.
2. Plating
 - 2.1: Contact: Tin over Nickel.
 - 2.2: LEG: Tin over Nickel.
3. Rating:
 - 3.1: CURRENT RATING: 1A AC, DC
 - 3.2: VOLTAGE RATING: 100V AC, DC
 - 3.3 OPERATING TEMPERATURE: -25°C ~ +85°C

ORDER INFORMATION
1201 0 3 3 XX 1

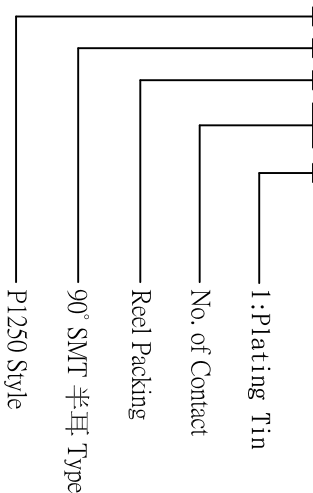

PIN NO.	Dimension			
	A	B	C	D
02P	1.25	7.25	7.65	3.05
03P	2.50	8.50	8.90	4.30
04P	3.75	9.75	10.15	5.55
05P	5.00	11.00	11.40	6.80
06P	6.25	12.25	12.65	8.05
07P	7.50	13.50	13.90	9.30
08P	8.75	14.75	15.15	10.55
09P	10.00	16.00	16.40	11.80
10P	11.25	17.25	17.65	13.05
11P	12.50	18.50	18.90	14.30
12P	13.75	19.75	20.15	15.55
13P	15.00	21.00	21.40	16.80
14P	16.25	22.25	22.65	18.05
15P	17.50	23.50	23.90	19.30
16P	18.75	24.75	25.15	20.55



钰满荣企业股份有限公司 ACME LUX CO., LTD.

TEL: 886-2-85124595

FAX: 886-2-85124322

0.0±0.30	SCALE: 1:1	TITLE:	PART NO:
0.00±0.20	UNIT: mm	MX 1.25 Pitch 90° SMT Type	APP BY: Hung
0.000±0.1		Water Connector	CHK BY: Cheryl

MATL: RoHS	DWG. NO. C1201033XX1	DR BY: Amos
------------	----------------------	-------------

REV.	DESCRIPTION	APP.	DATE
A	NEW DESIGN	Amos	2011-10-31

